

Chain Conveyors SRF-P 2010

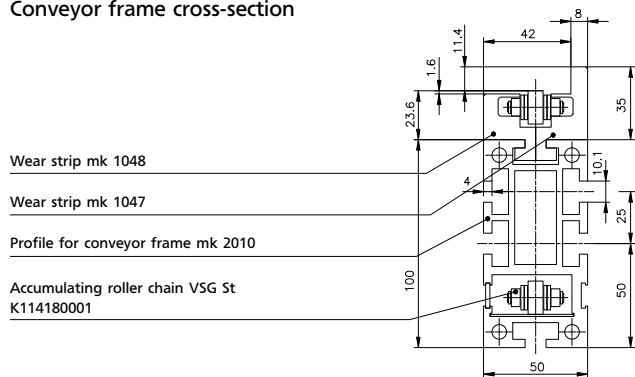

Conveyor frame cross-section





Accumulating roller chain conveyor SRF-P 2010 is designed for the transport and accumulation of loads up to 750 kg (1650 lbs). As pallets travel on the large idler rollers, the conveyor is very quiet even at accumulation zones. The force required to hold accumulating pallets is minimal. Typical applications include product

transfer between workstations or accumulation of products between processes. Entire handling systems can be designed using this conveyor system. T-slots are accessible on three sides on the profile frame for the attachment of stands, side rails, sensors and stops (10 mm opening).

SRF-P 2010 AA

Accumulating roller chain conveyor with head drive, without motor

B20.10.554

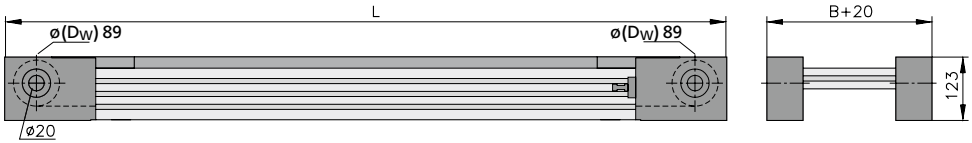

Wear strip options see page 191

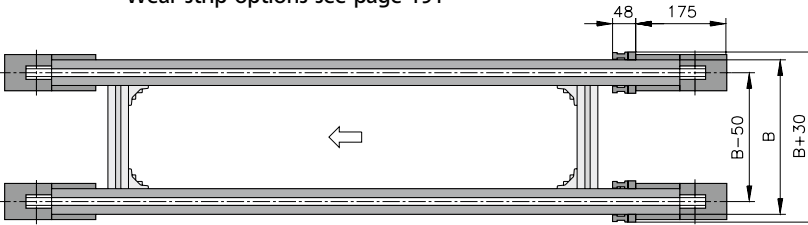

Drive version AA is primarily used where multiple lanes are to be slave driven, either parallel or in-line, using a single drive motor. Depending on the requirement, the conveyor is designed either with a hollow shaft or with a connecting shaft with shaft journal ($\phi 20$ mm, usable length 34 mm, incl. feather key DIN 6885).

	Dimensions – technical information	Notes
Conveyor length L	between 500-10000 mm	any increment possible
Conveyor width B	200 to 2000 mm	
Chain	accumulating roller chain 1/2" with plastic or steel roller	see from page 202
Drive and speed	to 30 m/min (100 ft/min)	see chart on page 12
Stands and side rails		see from page 262
Load capacity	total load to 750 kg (1650 lbs) section load to 100 kg/m (in series) section load to 150 kg/m (offset)	higher on request

SRF-P 2010 AC

Accumulating roller chain conveyor with head drive standard

B20.10.555

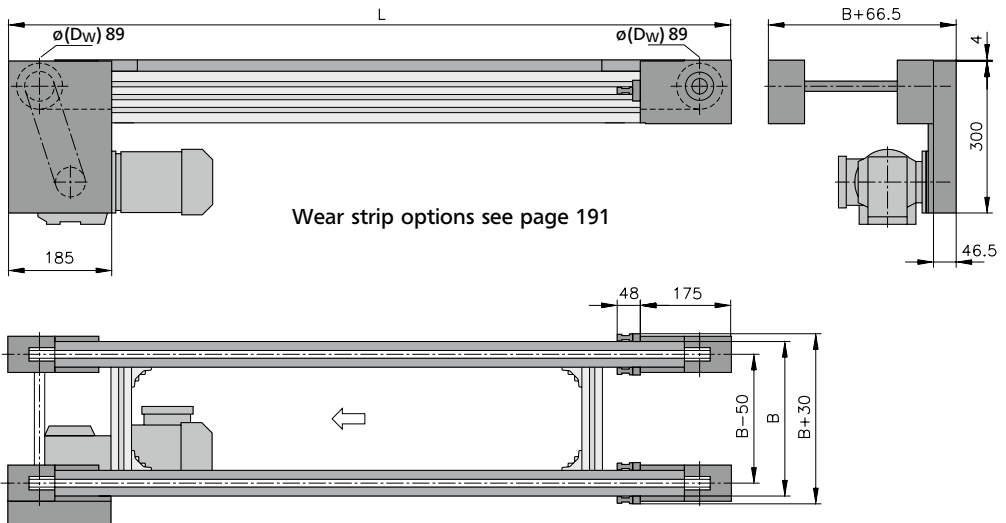

The sprocket ensures outstanding transmission of the motor power.

	Dimensions – technical information	Notes
Conveyor length L	between 500-10000 mm	any increment possible
Conveyor width B	200 to 2000 mm	
Chain	accumulating roller chain 1/2" with plastic or steel roller	see from page 202
Drive location	discharge side left/right	
Drive and speed	to 30 m/min (100 ft/min)	see chart on page 12
Stands and side rails		see from page 262
Load capacity	total load to 750 kg (1650 lbs) section load to 100 kg/m (in series) section load to 150 kg/m (offset)	higher on request

SRF-P 2010 AF

Accumulating roller chain conveyor with head drive, direct

B20.10.561

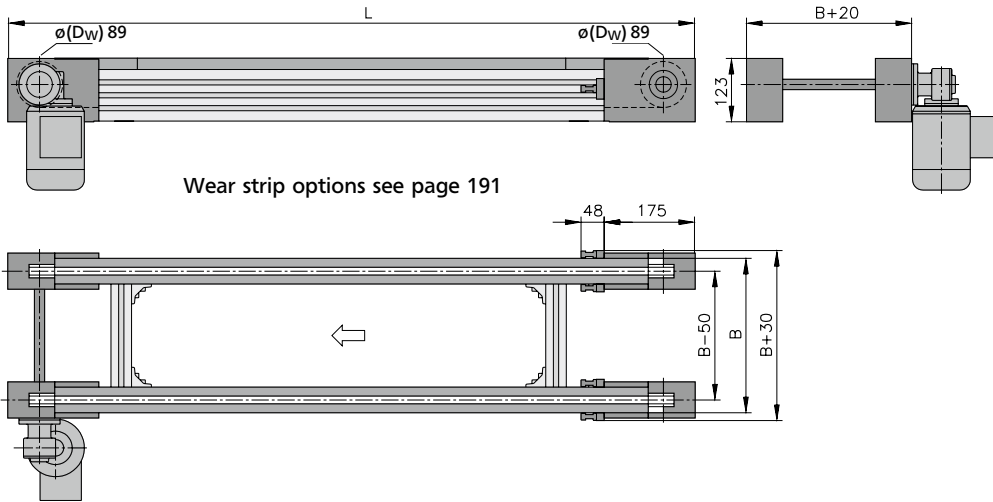

By placing the motor directly onto the drive shaft, this drive version minimizes not only the space required at the drive yet also the number of moving parts and maintenance requirements.

	Dimensions – technical information	Notes
Conveyor length L	between 500-10000 mm	any increment possible
Conveyor width B	200 to 2000 mm	
Chain	accumulating roller chain 1/2" with plastic or steel roller	see from page 202
Drive location	discharge side left/right	
Drive and speed	to 30 m/min (100 ft/min)	see chart on page 12
Stands and side rails		see from page 262
Load capacity	total load to 750 kg (1650 lbs) section load to 100 kg/m (in series) section load to 150 kg/m (offset)	higher on request

SRF-P 2010 AS

Accumulating roller chain conveyor with outside head drive

B20.10.559

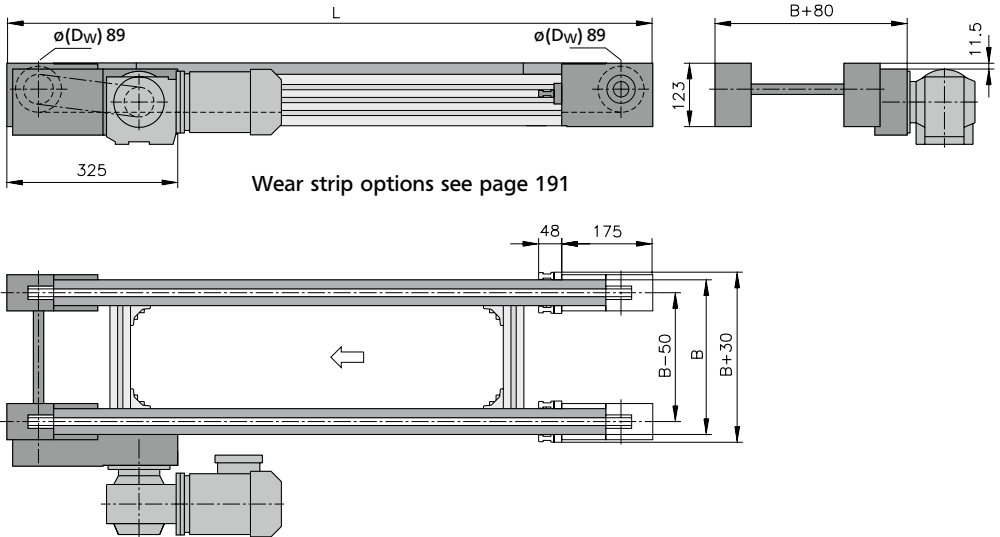

The overall height of the drive assembly is held to an absolute minimum.

	Dimensions – technical information	Notes
Conveyor length L	between 700-10000 mm	any increment possible
Conveyor width B	200 to 2000 mm	
Chain	accumulating roller chain 1/2" with plastic or steel roller	see from page 202
Drive location	discharge side left/right	
Drive and speed	to 30 m/min (100 ft/min)	see chart on page 12
Stands and side rails		see from page 262
Load capacity	total load to 750 kg (1650 lbs) section load to 100 kg/m (in series) section load to 150 kg/m (offset)	higher on request

SRF-P 2010 AQ

Accumulating roller chain conveyor with head drive, dual-strand

B20.10.558

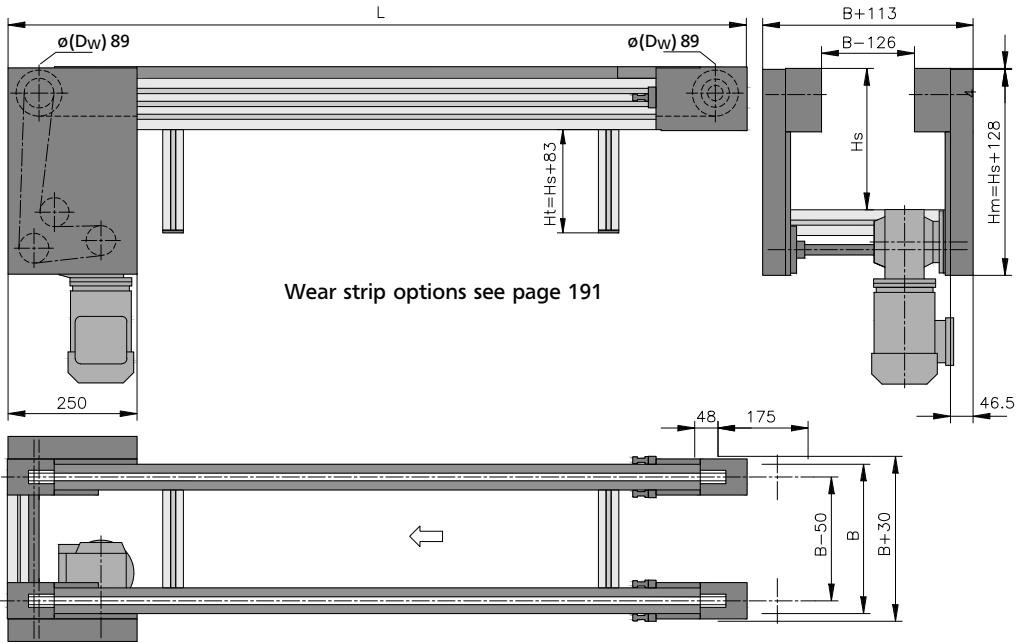

In principle, the drive concept of the AQ version is the same as for the AC version. This drive is used when the goods to be transported or the pallets require a free space between the conveyor strands.

	Dimensions – technical information	Notes
Conveyor length L	between 500-10000 mm	any increment possible
Conveyor width B	200 to 2000 mm	
Chain	accumulating roller chain 1/2" with plastic or steel roller	see from page 202
Drive location	discharge side left/right	
Drive and speed	to 30 m/min (100 ft/min)	see chart on page 12
Stands and side rails		see from page 262
Load capacity	total load to 750 kg (1650 lbs) section load to 100 kg/m (in series) section load to 150 kg/m (offset)	higher on request

SRF-P 2010 BC

Accumulating roller chain conveyor with center drive standard

B20.10.560

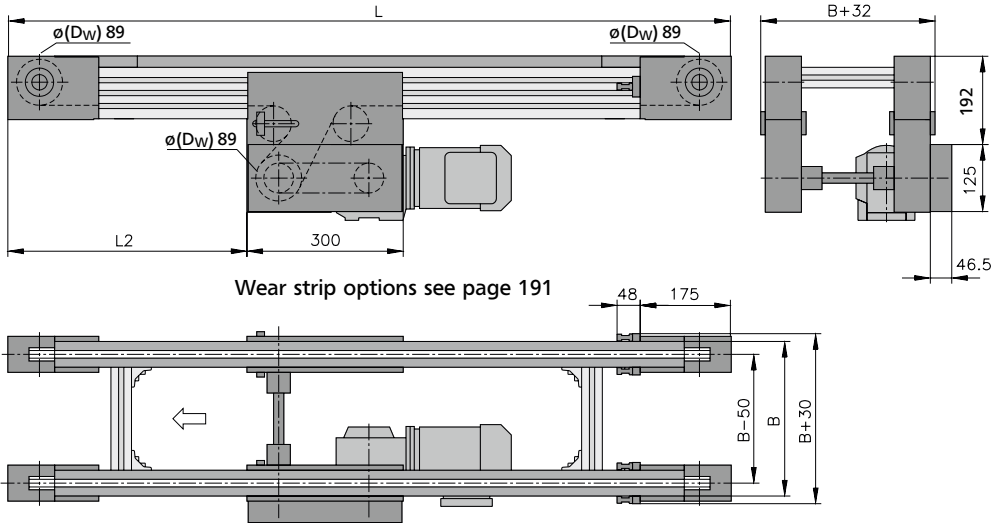

The compact design, and the ability to assemble the drive location anywhere along the conveyor frame (during manufacture), simplifies the integration of this conveyor into new or existing equipment. The drive sprocket in conjunction with the snub rollers ensures an outstanding transmission of the motor torque.

	Dimensions – technical information	Notes
Conveyor length L	between 700-10000 mm	any increment possible
Conveyor width B	200 to 2000 mm	
Chain	accumulating roller chain 1/2" with plastic or steel roller	see from page 202
Drive location	left/right below	
Drive and speed	to 30 m/min (100 ft/min)	see chart on page 12
Stands and side rails		see from page 262
Load capacity	total load to 750 kg (1650 lbs) section load to 100 kg/m (in series) section load to 150 kg/m (offset)	higher on request

SRF-P 2010 BF

Accumulating roller chain conveyor with center drive, direct

B20.10.563

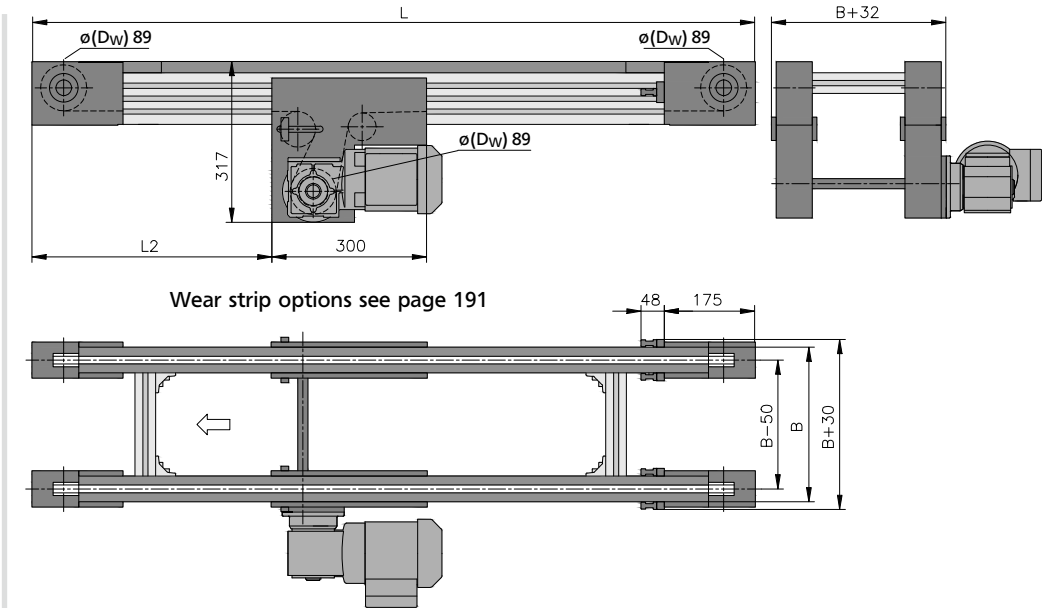

Thanks to the motor fitted directly onto the drive shaft, for this drive version, the spatial requirements and the maintenance effort are reduced to a minimum. The compact conveyor frame structure, and the possibility of freely selecting the drive position over the entire length of the conveyor, facilitate integration of the conveyor in existing systems. The travel direction is reversible. Operation with cleats is not possible with this version.

	Dimensions – technical information	Notes
Conveyor length L	between 700-10000 mm	any increment possible
Conveyor width B	200 to 2000 mm	
Chain	accumulating roller chain 1/2" with plastic or steel roller	see from page 202
Drive location	left/right below	
Drive and speed	5; 6,3; 8; 9,5; 11,5; 13,5; 15,2; 19,3; 23; 26; 36,6; 45,7 and 57 m/min	see chart on page 12
Stands and side rails		see from page 262
Load capacity	total load to 750 kg (1650 lbs) section load to 100 kg/m (in series) section load to 150 kg/m (offset)	higher on request

SRF-P 2010

Wear strips

mk Guide- and wear strips feature low friction and high wear resistance.
The wear strips are made of PE-UHMW (PE-1000). Temperature max. 65° C (149° F).

Option A

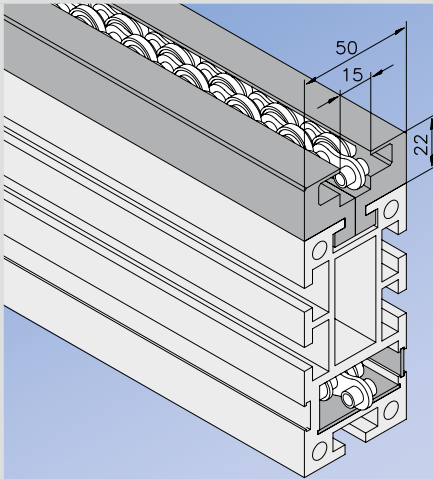

Wear strip above mk 1048, 22.48.2000
Wear strip below 21.14.0001
Closure strip K10230/12

Option B

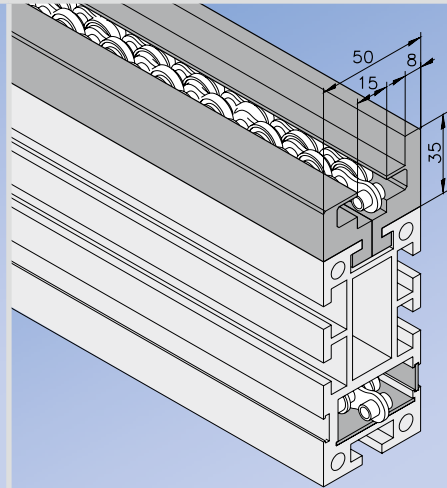

Wear strip above right mk 1047, 22.47.2000
Wear strip above left mk 1048, 22.48.2000
Wear strip below 21.14.0001
Closure strip K10230/12