

Incline Steel Link Belt Conveyors KFS-P 2040.86

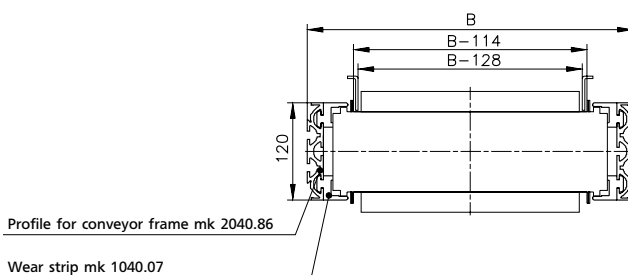

Conveyor frame cross-section

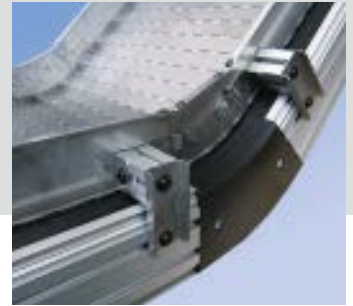



With its compact design using our aluminum profile systems, Conveyor System KFS-P 2040.86 is ideally suited for continuous duty applications in multiple shift environments. The belt is guided entirely on UHMW (PE1000) wear strips, and is designed for the removal or transport of stampings, castings, machined parts or bulk material handling. The belt is also available in stainless

steel, or with perforations. It is ideal for hot parts. With the modular construction using all the inherent benefits of our mk Profile Technology Systems, this conveyor can be readily integrated into new or existing equipment, or be used as a free-standing conveyor for bulk handling and loading applications. The conveyor frame features T-slots to which accessories including

stands, rails, hoppers or chutes can be easily mounted. Through this use of standard components, mk is in a position to deliver a truly versatile conveyor. Customer specific requirements, such as special hoppers, are possible on request. Depending on the product to be conveyed, please also consider our other Incline Conveyors featuring Modular Plastic or Fabric belting.

KFS-P 2040.86 AC

Incline steel link belt conveyor with head drive standard

Type S: B20.40.606, type K: B20.40.607, type L: B20.40.608, type G: B20.40.605

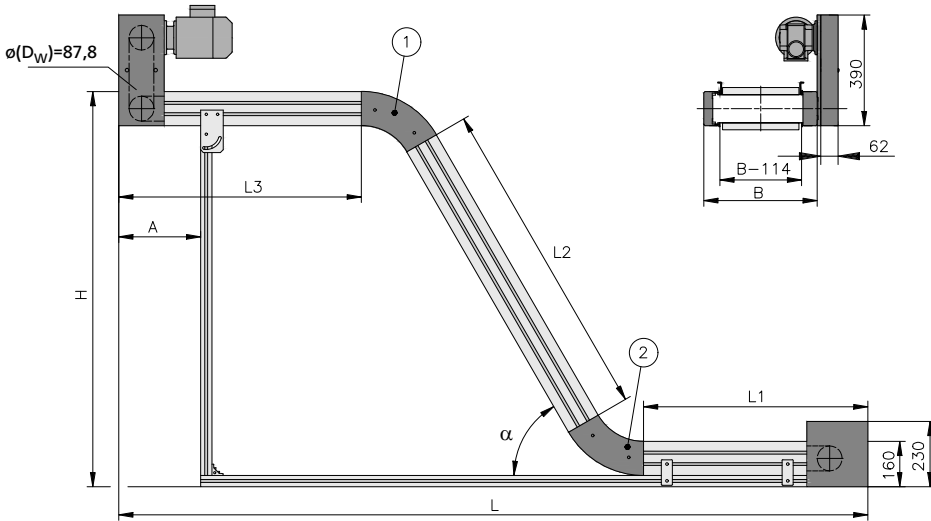

Steel drive sprockets positively engage roller chains on the underside of the belt and ensure proper grip and tracking.

	Dimensions – technical information	Notes
Conveyor length L (L1+L2+L3)	depending on conveyor design and load to 10000 mm	any increment possible
Conveyor width B	210 to 710 mm (in 50 mm increments)	others on request
Drive location	discharge side left/right below/above	
Drive and speed	to 12 m/min (39 ft/min)	see chart on page 12
Stands and side rails		see page 132
Load capacity	total load to 150 kg (330 lbs) section load to 50 kg/m, 15 kg/field	see chart on page 114
Bends α 1 and 2	15, 30, 45 and 60°	

KFS-P 2040.86 AS

Incline steel link belt conveyor with outside head drive

Type S: B20.40.610, type K: B20.40.611, type L: B20.40.612, type G: B20.40.609

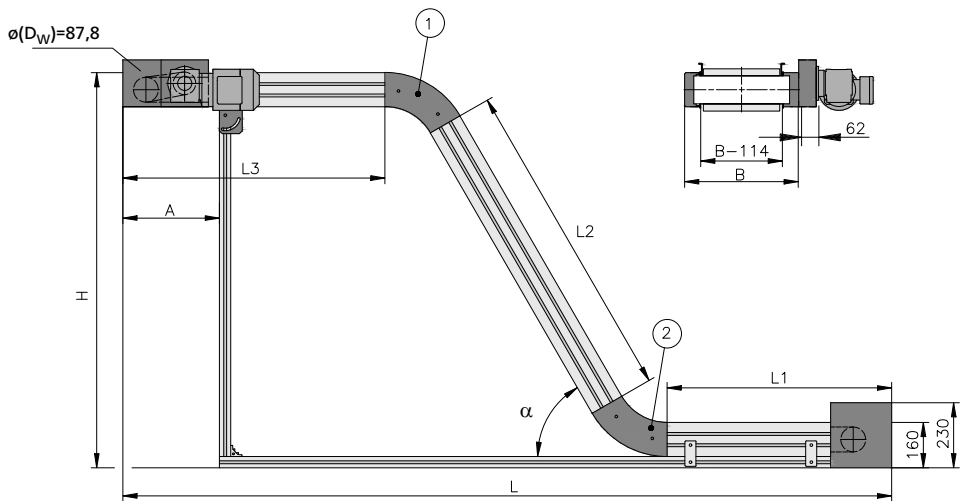

The overall height of the conveyor is held to an absolute minimum. The molded drive sprockets positively engage with the underside of the belt and ensure proper grip and tracking.

	Dimensions – technical information	Notes
Conveyor length L (L1+L2+L3)	depending on conveyor design and load to 10000 mm	any increment possible
Conveyor width B	210 to 710 mm (in 50 mm increments)	others on request
Drive location	discharge side left/right	
Drive and speed	to 12 m/min (39 ft/min)	see chart on page 12
Stands and side rails		see page 132
Load capacity	total load to 150 kg (330 lbs) section load to 50 kg/m, 15 kg/field	see chart on page 114
Bends α 1 and 2	15, 30, 45 and 60°	

KFS-P 2040.86

Stands and side rails

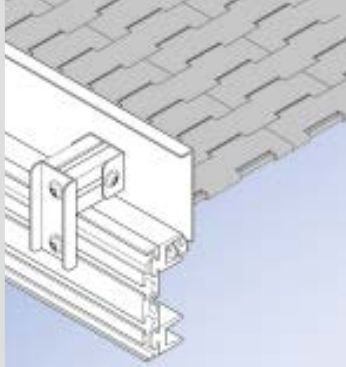

Side rails

The example shows our standard side rails. They are designed to minimize the gap between the conveyor frame and the modular belt (up to 1-3 mm).

Side Rail SF 8.1

B17.00.026

Height H = 75 mm
Height H = 100 mm

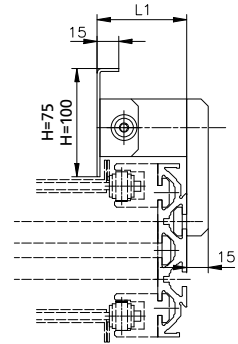

Stand type A

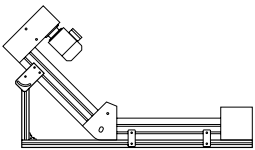
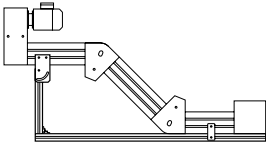

Stands

The stand type A shown can be furnished with all pad options. If ordering configuration type G, all stands of the mk conveyor technology system can be utilized.

The pad option 1 features swivel casters with total lock brakes which guarantee stable support even at high speeds.

Castors are available with $\varnothing 75$ mm for $x = 113$ mm, $\varnothing 100$ mm for $x = 140$ mm and $\varnothing 125$ mm for $x = 165$ mm.

Pad option 1

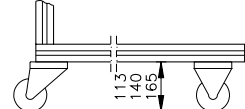

Pad option 2

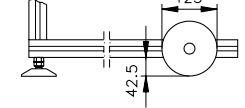

Pad option 3

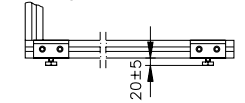

Order example

KFS-P 2040.86 type S (B20.40.606)

Drive version AC, motor orientation 0° as shown

Speed 10 m/min

Width B = 460 mm

Length L1 = 500 mm; L2 = 1000 mm; L3 = 600 mm

Bend $\alpha 1 = 60^\circ$; Bend $\alpha 2 = 60^\circ$

Cleat Height H1 = 20 mm (see page 133)

Stand Type A, pad option 1, Roll $\varnothing 75$ mm

Feed height ELH = 200 mm

Discharge height ALH = 1200 mm

Type configuration

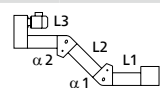
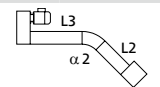
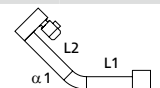
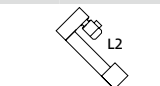
	Drive	AC	AS
Type S 	B20.40. ...	606	610
Type K 	B20.40. ...	607	611
Type L 	B20.40. ...	608	612
Type G 	B20.40. ...	605	609

KFS-P 2040.86

Flat top chains

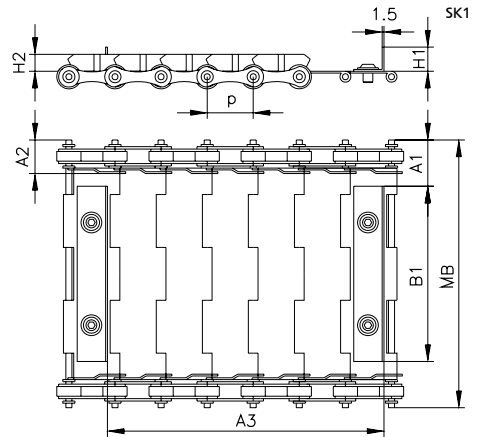

Flat top chain type

SK1

A1 (without sidewalls/with sidewalls)

38.1 mm

A2

25.5 mm

MB

146.5-645.5 mm

Cleat height H1

20/40 mm

Sidewall height H2

14 mm

Cleat spacing A3

38.1 mm increments

Color

steel

Pitch p

38.1 mm

Belt thickness

13 mm

Material

steel

FDA/USDA suitability

no

Technical properties

steel
wear resistant
heat resistant to 300° C
shockproof
low friction