

Incline Belt Conveyors KFG-P 2000

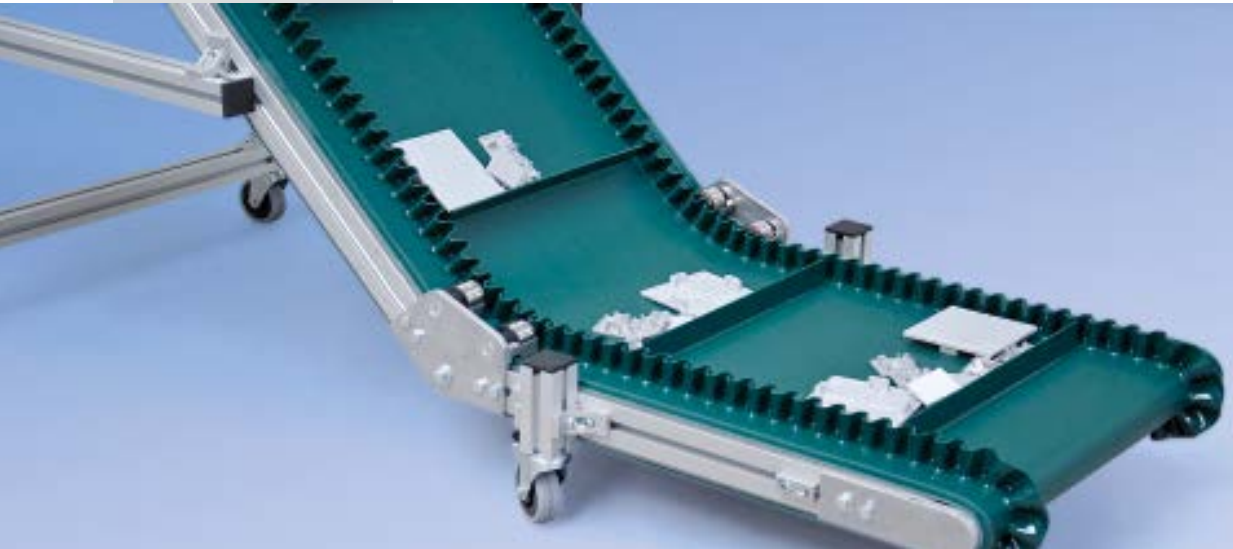

Conveyor frame cross-section

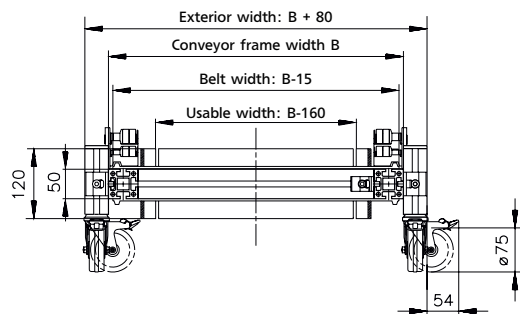

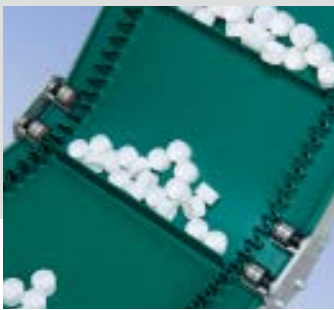

With its' compact design using our structural aluminum Profile mk 2000, Conveyor System KFG-P 2000 is ideally suited for continuous duty applications in multiple shift environments. Used primarily for the transport of small parts, the belt is guided through the incline by welded-on V-guides.

As with all mk conveyors, belt alignment is easy with our standard crowned rollers. Additional features include a stainless steel slider bed mounted to the conveyor frame which reduces wear on the belt and the use of sealed ball bearings for overall conveyor life and performance. Using all

the inherent benefits of modular construction with our mk Profile Technology System, this conveyor can be readily integrated into new or existing equipment, or be used as a free-standing conveyor for bulk handling and loading applications.

KFG-P 2000 AC

Incline belt conveyor with head drive standard

B20.00.010

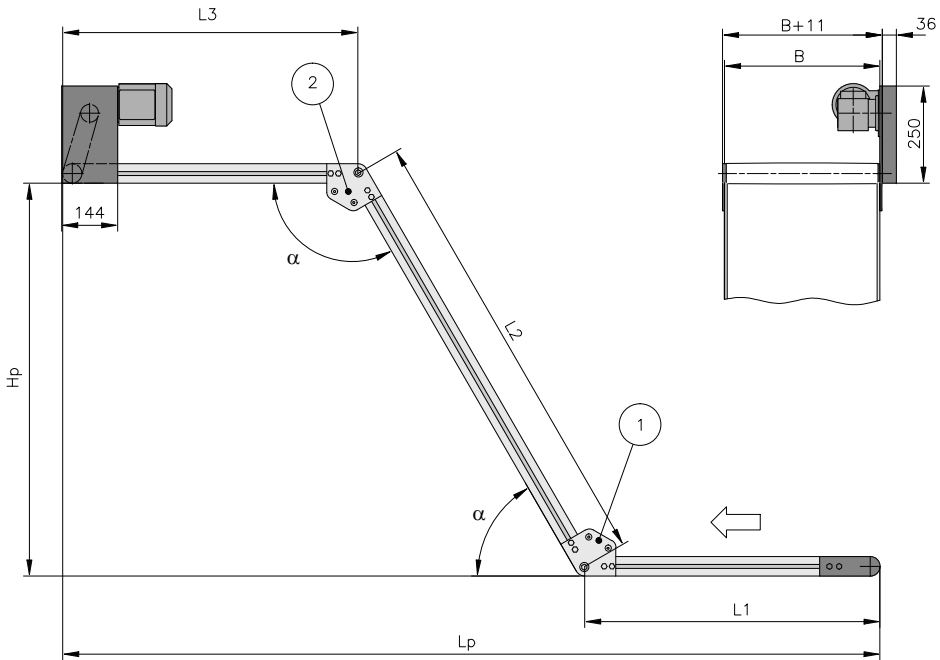

The $\varnothing 52$ mm drive roll provides good belt wrap and efficient motor power transmission, and the compact construction simplifies the integration of the conveyor into existing equipment.

	Dimensions – technical information	Notes
Conveyor length L (L1+L2+L3)	variable to approx. 4000 mm L1/L3 min. = 400, L2 min. = 600	any increment possible
Conveyor width B	300 to 700 mm (in 100 mm increments)	others on request
Drive location	discharge side left/right below/above	
Drive and speed	to 15 m/min (50 ft/min)	others on request
Stands and side rails		see page 74
Load capacity	total load to 40 kg (88 lbs) section load to 25 kg (55 lbs)/m, 5 kg/field	higher on request
Bends α	30, 45 and 60°	others on request
Product	height to 55 mm, length to 300 mm	others on request

KFG-P 2000 AF

Incline belt conveyor with head drive, direct

B20.00.010

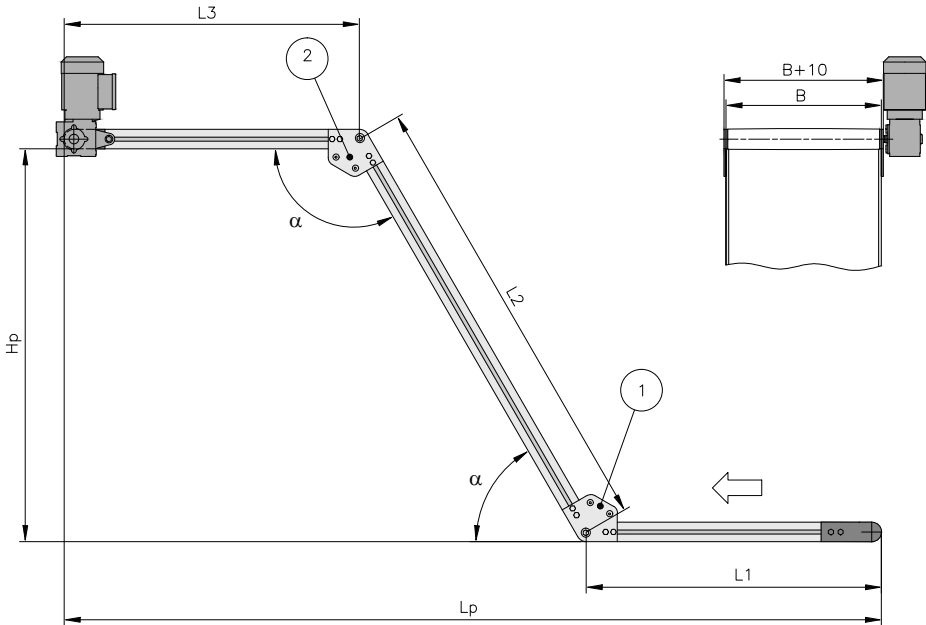

By placing the motor directly onto the drive shaft, this drive version minimizes not only the space required at the drive yet also the number of moving parts and maintenance requirements.

	Dimensions – technical information	Notes
Conveyor length L (L1+L2+L3)	variable to approx. 4000 mm L1/L3 min. = 400, L2 min. = 600	any increment possible
Conveyor width B	300 to 700 mm (in 100 mm increments)	others on request
Drive location	discharge side left/right	
Drive and speed	2,8; 5,4; 10,9; 14,9 m/min	others on request
Stands and side rails		see page 74
Load capacity	total load to 40 kg (88 lbs) section load to 25 kg (55 lbs)/m, 5 kg/field	higher on request
Bends α	30, 45 and 60°	others on request
Product	height to 55 mm, length to 300 mm	others on request

KFG-P 2000 AS

Incline belt conveyor with outside head drive

B20.00.010

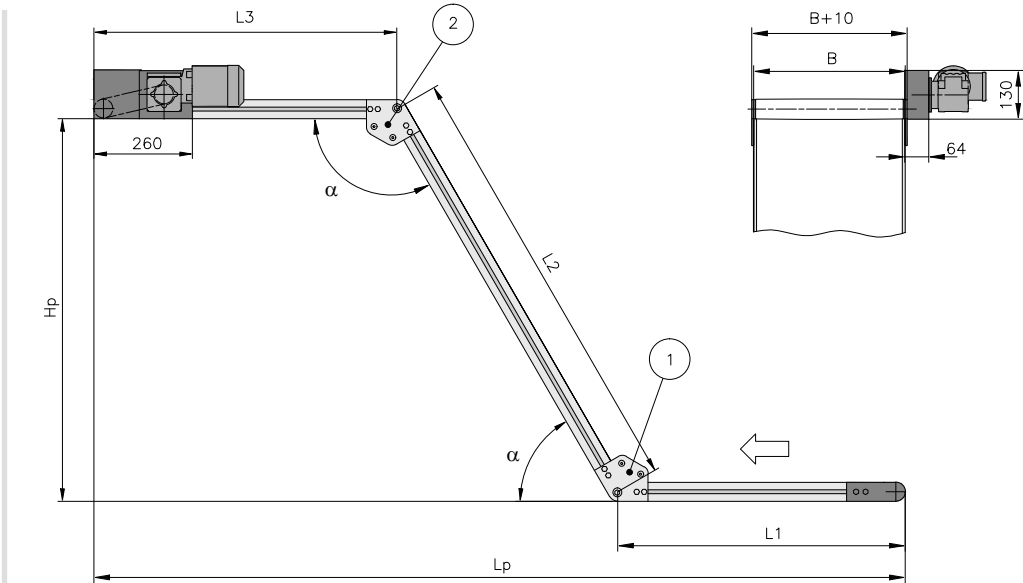

The \varnothing 52 mm drive roll provides good belt wrap and efficient motor power transmission, and the compact construction simplifies the integration of the conveyor into existing equipment.

	Dimensions – technical information	Notes
Conveyor length L (L1+L2+L3)	variable to approx. 4000 mm L1/L3 min. = 400, L2 min. = 600	any increment possible
Conveyor width B	300 to 700 mm (in 100 mm increments)	others on request
Drive location	discharge side left/right	
Drive and speed	to 15 m/min (50 ft/min)	others on request
Stands and side rails		see page 74
Load capacity	total load to 40 kg (88 lbs) section load to 25 kg (55 lbs)/m, 5 kg/field	higher on request
Bends α	30, 45 and 60°	others on request
Product	height to 55 mm, length to 300 mm	others on request

KFG-P 2000 AU

Incline belt conveyor with outside head drive

B20.00.010

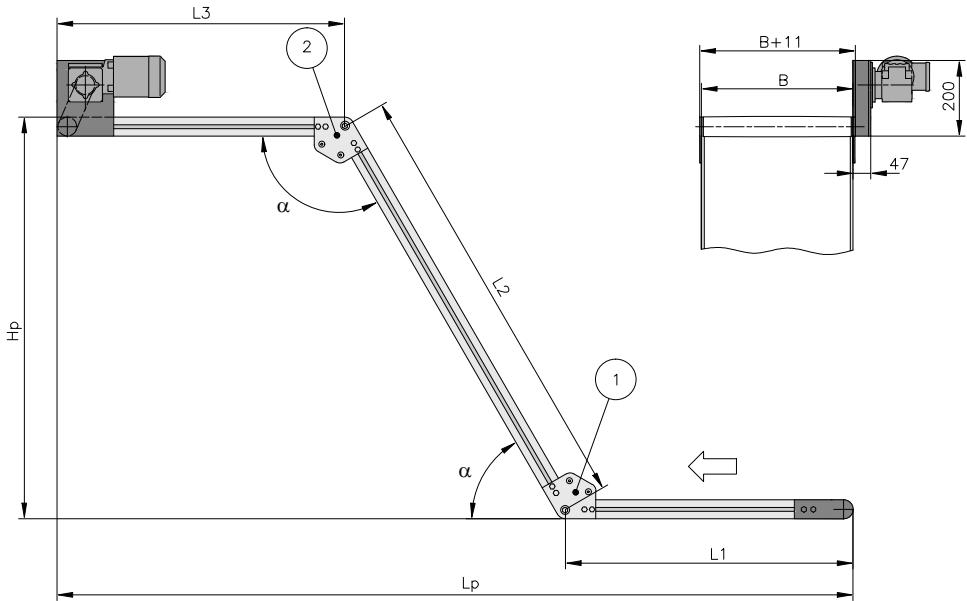

The $\varnothing 52$ mm drive roll provides good belt wrap and efficient motor power transmission, and the compact construction simplifies the integration of the conveyor into existing equipment.

	Dimensions – technical information	Notes
Conveyor length L (L1+L2+L3)	variable to approx. 4000 mm L1/L3 min. = 400, L2 min. = 600	any increment possible
Conveyor width B	300 to 700 mm (in 100 mm increments)	others on request
Drive location	discharge side left/right below/above	
Drive and speed	to 15 m/min (50 ft/min)	others on request
Stands and side rails		see page 74
Load capacity	total load to 40 kg (88 lbs) section load to 25 kg (55 lbs)/m, 5 kg/field	higher on request
Bends α	30, 45 and 60°	others on request
Product	height to 55 mm, length to 300 mm	others on request

KFG-P 2000 ECO

Incline conveyor with fixed variants, fast availability

B20.00.015

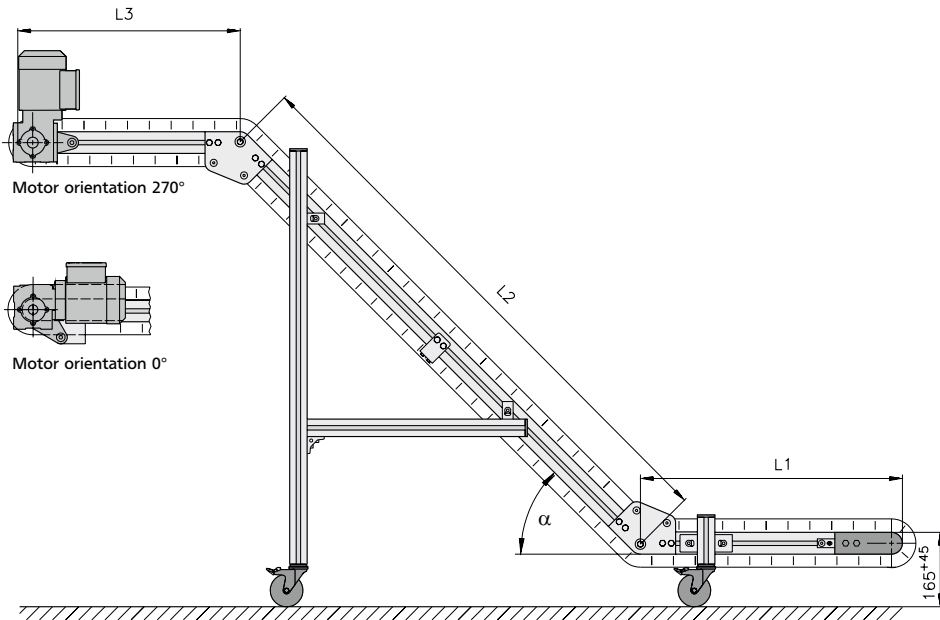

ECO stands for economy, i.e. high quality materials and fulfillment of customer requirements at an attractive price. Thanks to the limited number of options, fast delivery and high availability are ensured. With the optimal ratio of effective width to total width the conveyor is ideally suited for integration in existing systems. Thanks to the mobility it can be used flexibly as a movable transport unit for filling containers or wire-mesh boxes.

Dimensions – technical information

Conveyor length L	L1 = 600 mm, L2 = 1300/1800 mm, L3 = 500 mm
Conveyor frame width B	400, 500, 600 mm (usable width: B-160 mm)
Drive location	discharge side left/right above, motor orientation 270°, for additional charge 0°
Drive and speed	2,8; 5,4;10,9;14,9 m/min, other speeds on request or via Reglomat
Load capacity	depending on incline and speed up to 40 kg
Bends α	30, 45 and 60°
Product	height to 55 mm, length to 300 mm, weight to 5 kg/field
Belt	GU-V0106-028DG
Cleats and sidewalls	height lateral cleats MT30 and sidewalls 30 mm, Polyurethane, green for L2=1300 16 lateral cleats with cleat spacing of 303 mm for L2=1800 19 lateral cleats with cleat spacing of 308 mm

KFG-P 2000 ECO

Variants

B20.00.015

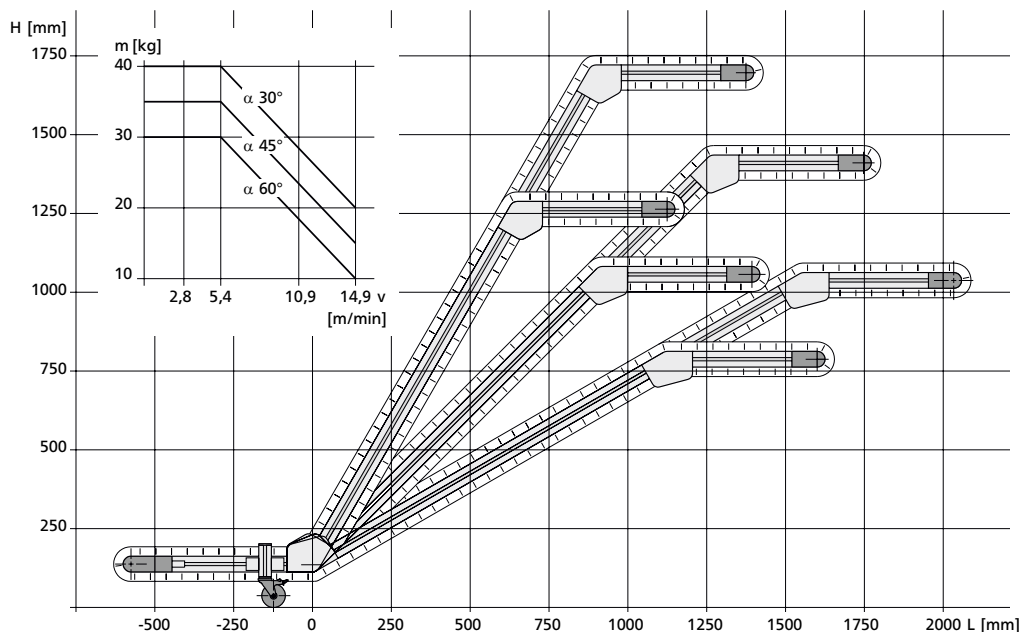

See the table for the optimal variant for your application. Without additional information the conveyor is designed with a drive location 270° top, front left, and speed 5.4 m/min.

Variant (L2 1300 mm)	A1	A2	A3	A4	A5	A6	A7	A8	A9
Conveyor frame width B [mm]	400	400	400	500	500	500	600	600	600
Conveyor bend α	30°	45°	60°	30°	45°	60°	30°	45°	60°

Variant (L2 1800 mm)	B1	B2	B3	B4	B5	B6	B7	B8	B9
Conveyor frame width B [mm]	400	400	400	500	500	500	600	600	600
Conveyor bend α	30°	45°	60°	30°	45°	60°	30°	45°	60°

KFG-P 2000

Stands

Stand, incline conveyor, type ECO

The stand, developed especially for the incline conveyor and incline conveyor modular belt, is characterized by its simplicity and light structure with the mk profile 2040.40.

Stand, infeed side B67.06.014

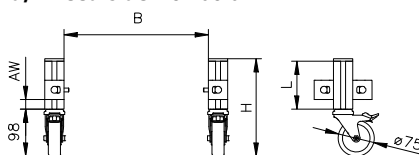

Feed height (ELH) = 166-349 mm

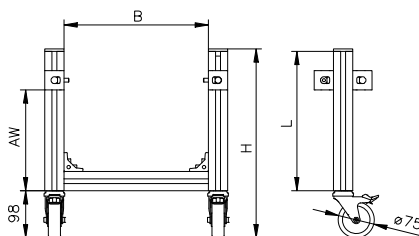

Feed height (ELH) = 350-500 mm

Stand, discharge side B67.06.015

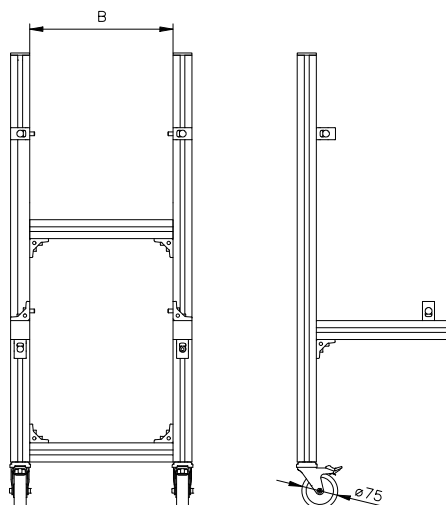

The swivel casters used can be completely arrested in place and thus guarantee safe stance, even at high transport speeds. Depending on the configuration, the stand is adapted in height and width, see the ordering example on the right.

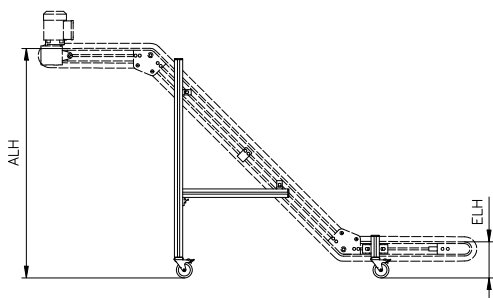

- ELH = Feed height
- ALH = Discharge height
- B = Conveyor frame width
- H = Height of the stand
- L = Length of the stand profile
- AW = Distance of the angle bracket to the profile edge

Side rails

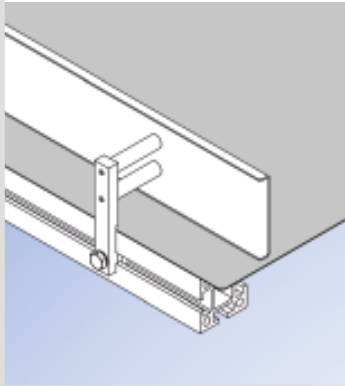

Side rails KFG-P 2000

Shown is our standard side rail for this conveyor style. It is designed to minimize the gap between the conveyor frame and the belt surface in order to avoid product loss and potential damage.

B17.00.035

Height 75 mm,
 others on request

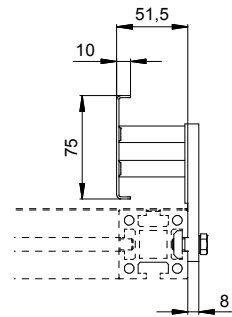

Order example

KFG-P 2000 type S (B20.00.010)

Drive AF, motor orientation 90° as shown

Speed 15 m/min

Width B = 500 mm

Length L1 = 500 mm; L2 = 1000 mm; L3 = 600 mm

Bend $\alpha 1 = 60^\circ$; bend $\alpha 2 = 60^\circ$

Cleat type T20 with side rail B17.00.035

Stand, incline conveyor, type ECO

Feed height ELH = 200 mm

Discharge height ALH = 1200 mm

Type configuration

Type S

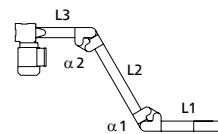

Type K

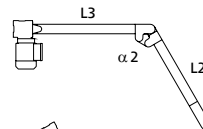

Type L

