

CHTPC WORM GEAR WITH PRE-STAGE MODULE

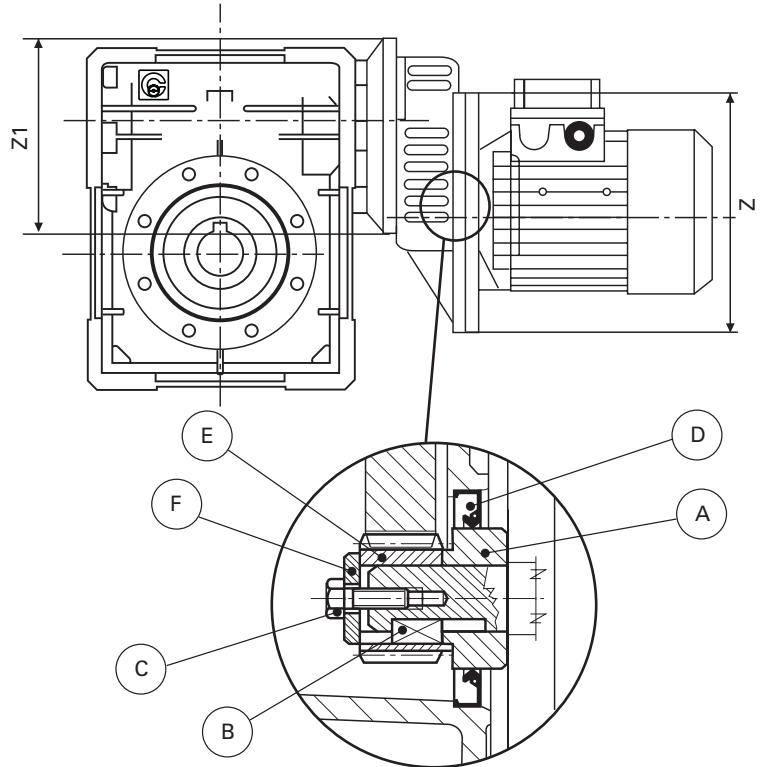
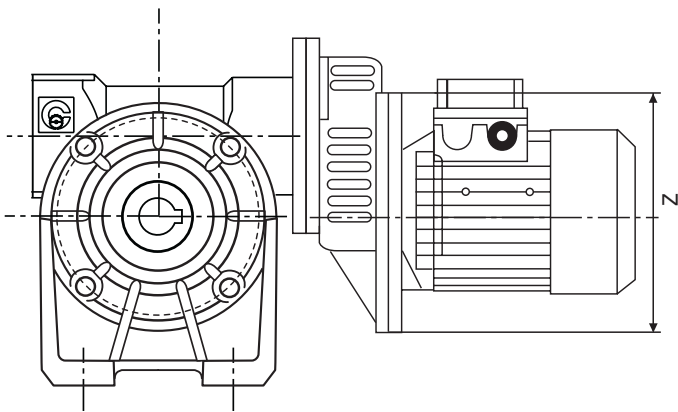

	Z	Z1
CHTPC 63	11/140	11/105
CHTPC 71	14/160	14/120
CHTPC 80	19/200	19/160

PINION ASSEMBLY INSTRUCTIONS

- 1) Assemble the spacer A (if necessary heat between 80° and 100° C) onto the driving shaft and block it with Loctite 638 for coaxial blockings
- 2) Insert the key B included in the kit
- 3) Assemble the pinion E (if necessary heat between 80° and 100° C) onto the driving shaft
- 4) Fix the washer F using the screw C
- 5) Assemble the oil seal D in the direction shown in the drawing
- 6) Insert the motor with the pinion, taking care not to damage the oil seal

Note: CHTPC pre-stage modul doesn't allow radial loads.

DESIGNATION CHTPC / CHB - CHB..P CHTPC / CHBE - CHB..P

TYPE	SIZE	i =	MMF
CHTPC	63	3	63B5
	71	3	71B5
	80	3	80B5

EXAMPLE ORDER

CHTPC 71 CHB 05 i= 108(3x36) P.A.M. 71

If the motor is also required, please specify:

Size es. 71 B4
 Power es. Kw 0.37
 Poles es. 4
 Voltage es. V230/400
 Frequency es. 50 Hz

CHTPC / CHB PERFORMANCE WITH 4-POLE MOTORS – 1400 REVS. INPUT

TYPE	i=ratio	n2 r/min	Kw=P1	Nm=T2
CHTPC63 CHB 04	105	13.3	0.12	42
	138	10.1	0.12	42
CHB 04	180	7.8	0.12	46
	210	6.7	0.12	40
	300	4.7	0.12	36

TYPE	i=ratio	n2 r/min	Kw=P1	Nm=T2
CHTPC71 CHB 05	84	16.7	0.25	80
	108	12.9	0.25	90
CHB 05	135	10.4	0.25	90

TYPE	i=ratio	n2 r/min	Kw=P1	Nm=T2
CHTPC71 CHB 07	120	11.7	0.55	280
	150	9.3	0.37	215
CHB 07	180	7.8	0.37	235
	240	5.8	0.37	210
	300	4.7	0.25	275

TYPE	i=ratio	n2 r/min	Kw=P1	Nm=T2
CHTPC71 CHB 08	168	8.3	0.55	350
	192	7.3	0.37	280
CHB 08	240	5.8	0.37	290
	300	4.7	0.37	275

TYPE	i=ratio	n2 r/min	Kw=P1	Nm=T2
CHTPC63 CHB 05	108	12.9	0.18	72
	135	10.4	0.18	85
CHB 05	180	7.8	0.12	65
	210	6.7	0.12	67
	240	5.8	0.12	58
	300	4.7	0.12	56

TYPE	i=ratio	n2 r/min	Kw=P1	Nm=T2
CHTPC71 CHB 06	114	12.3	0.37	170
	135	10.4	0.37	176
CHB 06	192	7.3	0.25	149
	240	5.8	0.25	130
	300	4.7	0.25	120

TYPE	i=ratio	n2 r/min	Kw=P1	Nm=T2
CHTPC80 CHB 07	90	15.6	0.75	310
	120	11.7	0.75	300
CHB 07	150	9.3	0.55	260

TYPE	i=ratio	n2 r/min	Kw=P1	Nm=T2
CHTPC80 CHB 08	120	11.7	0.75	390
	138	10.1	0.75	360
CHB 08	168	8.3	0.55	350
	192	7.3	0.55	330
	240	5.8	0.55	305

DIMENSIONS CHTPC/CHB

CHTPC../CHB 06-07-08

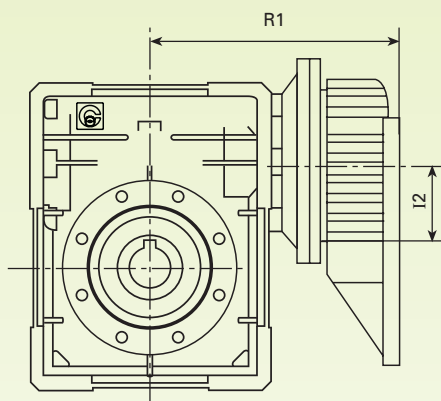

CHTPC../CHB 04 - 05

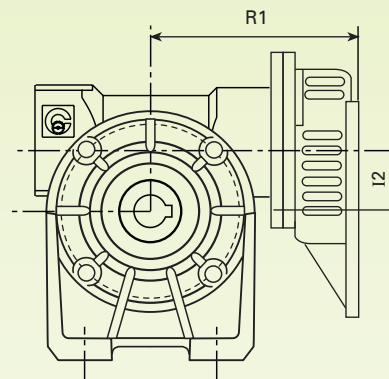

For other dimensions see pages 6 - 7 - 12 - 13 and 14 of the catalogue.

CHTPC - CHB	R1	I2
63 + 04	113	40
63 + 05	118	40
71 + 05	127	50
71 + 06	158	50
71 + 07	181	50
80 + 07	197	63
71 + 08	192	50
80 + 08	208	63

The choice of power installed is tied to the unification of the motors, therefore it is sometimes in exuberance compared to the gear; always verify the maximum torque indicated when making the selection and if in doubt please contact our technical office.